



H190v User Manual





Congratulations on your new Hegel H190v. All Hegel products are based on a simple philosophy: Add as little as possible. We work to keep the music signal as close to the original as possible. We are always looking for ways to lower distortion and noise so that the music is only limited by the quality of the recording.

H190v hits the sweet spot between price, performance, functionality, and user-friendliness. The 2x150 watt amplifier with our SoundEngine2 error canceling technology prevents distortion and preserves the details and dynamic range in the original music signal. Combined with a damping factor of over 4000, H190v is powerful enough to drive almost any loudspeaker on the market. It also has a good selection of analog and digital inputs and outputs, making it an ideal hub for any setup.

With streaming solutions like Spotify Connect, AirPlay, and Roon Ready, there are very few limits to what and how you can connect. There is also IP control, a good headphone output, and you can use common TV remotes to control the amplifier.

H190v even has a built-in phono preamplifier that is a scaled-down version of our award-winning V10 phono stage. Connecting your turntable to this input is sure to make all your vinyl recordings come to life.

H190v is a classic reborn.

A handwritten signature in black ink, appearing to read 'Bent Holter', with a long horizontal line extending to the right.

Bent Holter
Founder Hegel Music System

Index

A word from Bent	2
What's in the box	4
Quickstart	5
General Use	8
Connections	9
Remote Control	11
Network Setup	12
Streaming	13
Device Menu	14
General Information	17
Safety Instructions	18
Warranty and Disclaimers	19

IMPORTANT:

[Before powering on the amplifier, make sure you have read and understood the safety instructions and warnings on page 18!](#)

What's in the box

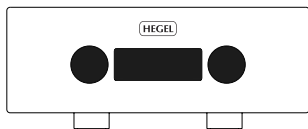

Amplifier

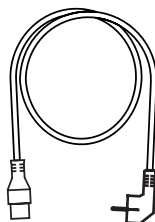

Power Cord



Accessory Box

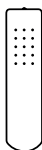

Remote Control

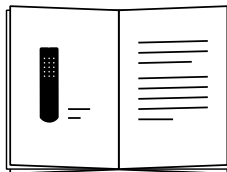

User Manual

Quickstart

1. Connect your speakers

For the best audio experience, the distance between the listener and each speaker should be the same.

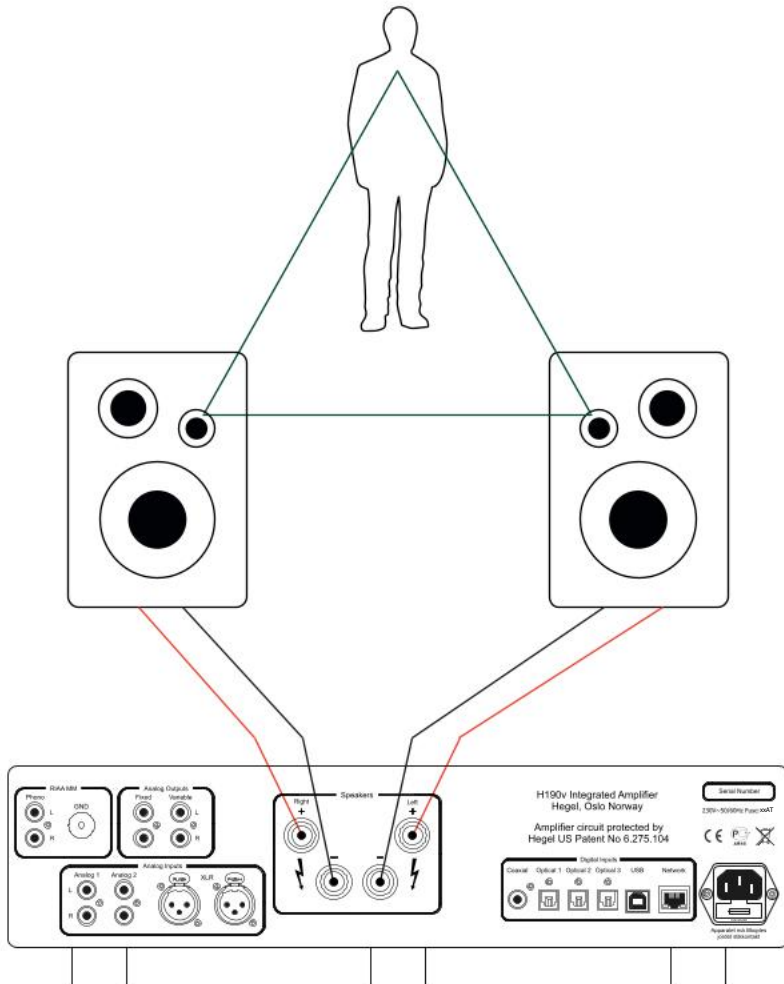

2. Connect a source

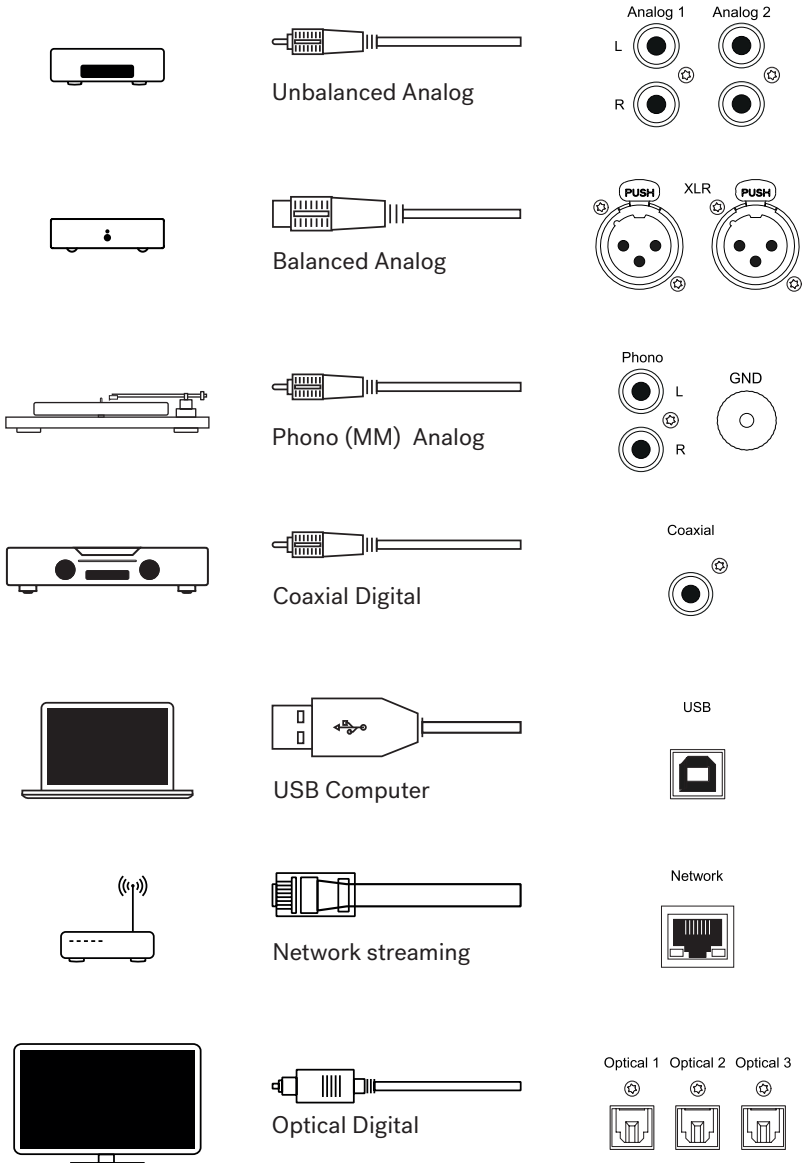

3. Connect the power cord

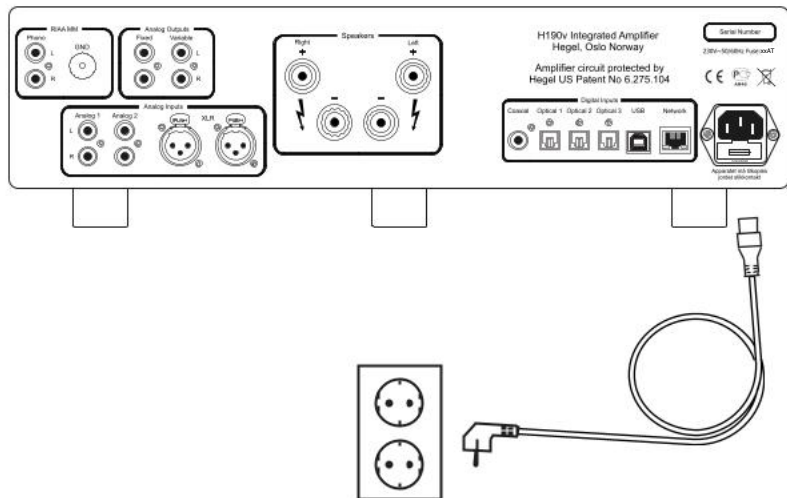

4. Turn on the amplifier

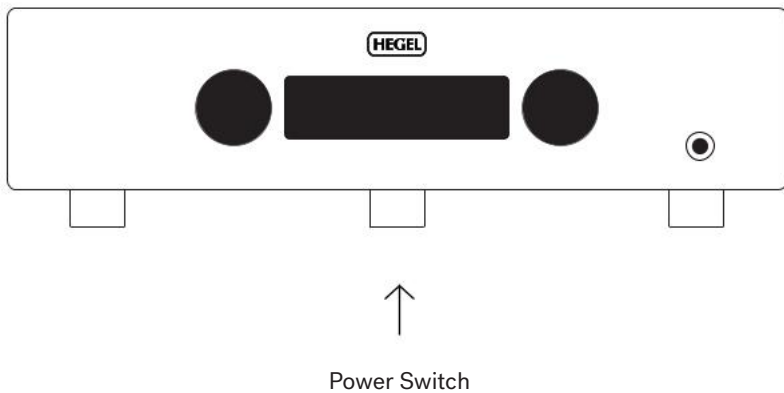

General Use

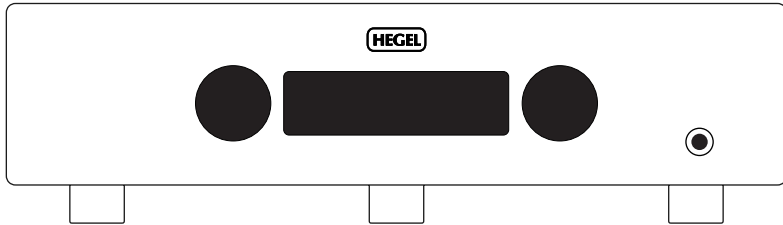

Operating the H190v

The source and volume can be changed using the input and volume selector on the front panel or using the remote control.

Power Button

The H190v amplifier can be switched on and off with the power button located on the underside of the amplifier, towards the front of the unit.

NOTE: When powering up, the H190v takes a few seconds to calibrate, the outputs are muted and the volume flashes to indicate that mute is on. This is normal and is part of the start-up procedure.

NOTE: When the H190v has been switched off, wait 30 seconds before powering it on again.

Headphone Output

Connect the 6.3mm headphone jack to the front of the H190v. This activates the headphone volume control and mutes the speaker outputs.

Sleep/Auto standby

In compliance with the EU Energy Efficiency Directive, the Hegel device will automatically switch off after 15 minutes without sensing a signal, or with a very low signal on the speaker outputs. You can disable or change the Sleep/ Auto Standby settings in the [Device Menu](#). When in standby, a small light in the bottom left corner of the display is lit.

Connections

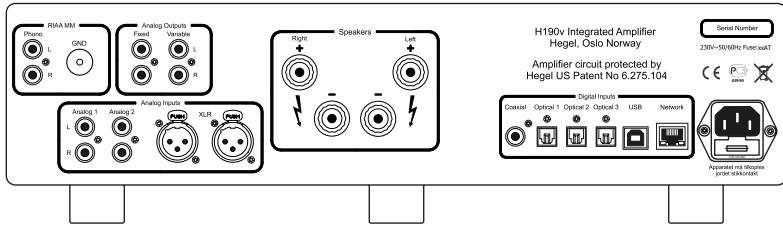

Always power the amplifier off before connecting input/output audio cables and the power cable.

Line Level Outputs

- Fixed Line level (RCA)
WARNING High-level output.
- Variable Line Level (RCA)

Analog Inputs

- Analog 1(RCA): Standard analog input
- Analog 2(RCA): Standard analog input
- XLR: Standard balanced analog input (Pin 1 is Chassis Ground; Pin 2 is Positive Phase; Pin 3 is Negative Phase)
- Phono (RCA): Moving Magnet (MM) cartridge input with ground screw

Speakers

- Right outputs
- Left outputs

Digital Connections

- Coaxial: Input Coaxial/RCA
- Optical1: Input TOSLINK/EIAJ Optical
- Optical2: Input TOSLINK/EIAJ Optical
- Optical3: Input TOSLINK/EIAJ Optical
- Computer USB input
- Home network connection (LAN - RJ45)

AC Power Connection

- AC Power connector with fuse holder:
230V/115V/100V AC depending on country.

Home Theater

Most inputs on the H190v can be used as a Home Theater input, see [Device Menu](#).

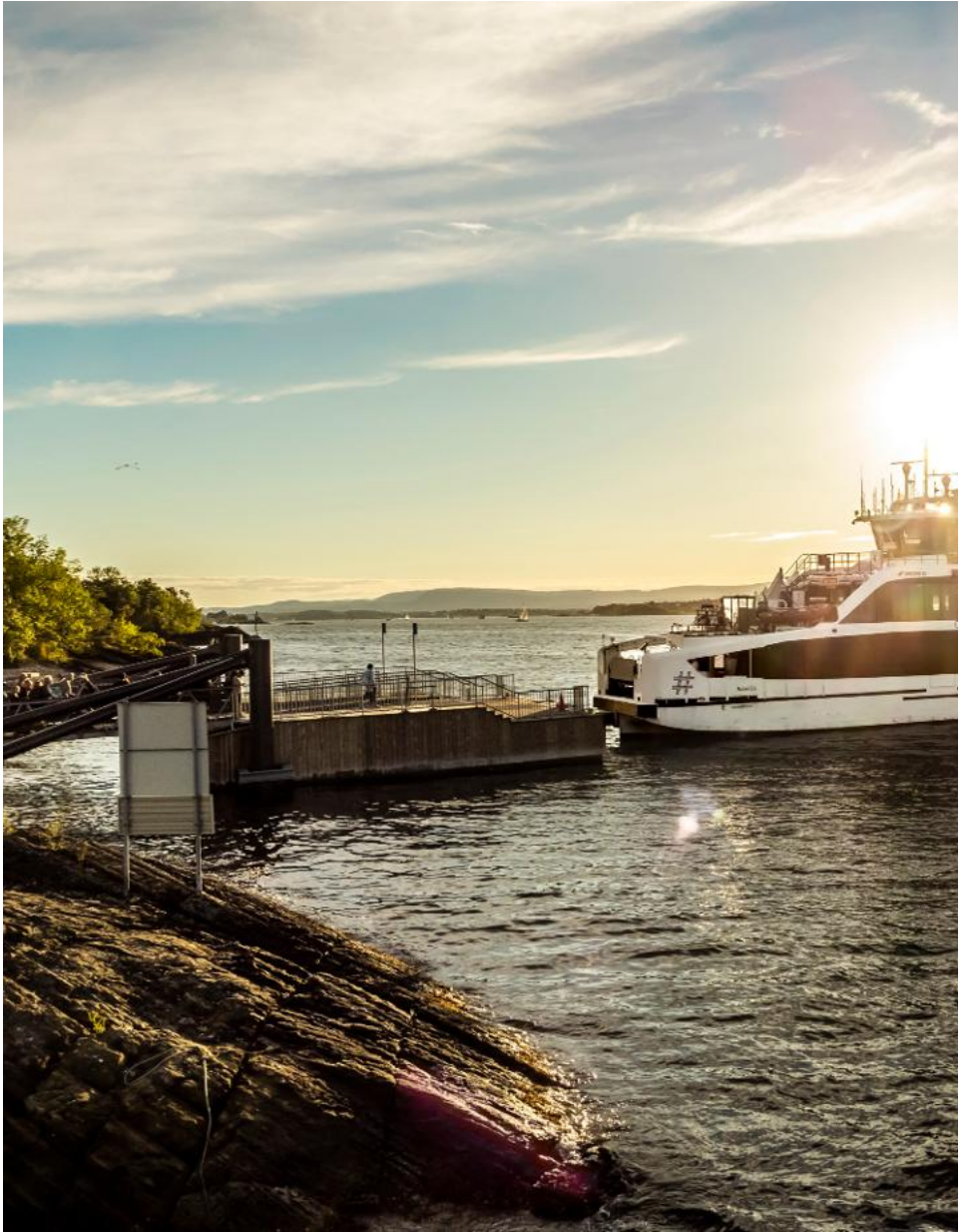

Remote Control - RC8

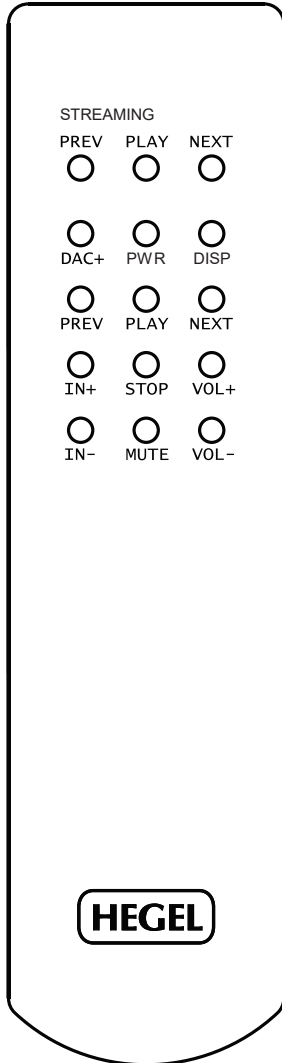

Remote control buttons

PREV	Skip backward on compatible USB or network media players
PLAY	Play/Pause on compatible USB or network media players
NEXT	Skip forward on compatible USB or network media players
DAC+	Input selector on DACs
PWR	Standby on amplifiers
DISP	Display on/off on amplifiers Hold for display off
PREV	Skip backward on CD-players Hold to rewind
PLAY	Play/Pause on CD-players
NEXT	Skip forward on CD-players Hold to fast forward
IN+	Switch to next input
STOP	Stop on CD-players
VOL+	Volume up
IN-	Switch to previous input
MUTE	Mute on amplifiers
VOL-	Volume down

General information

This Hegel device can be controlled with the included Hegel RC8 Remote Control. The RC8 also controls other Hegel products, such as CD players and preamplifiers, and most connected media players.

Batteries

The remote control uses two standard 1.5-volt LR03 AAA batteries.

To insert the batteries, use a crosshead (Phillips) screwdriver to remove the back lid. When reassembling, be careful not to overtighten the screws.

Network Setup

Connection

To be able to use the amplifier's network and streaming features, the amplifier needs to be connected to your local network.

Connect your Hegel amplifier using an Ethernet cable (not supplied) from the network connection (LAN - RJ45) port on the back of the amplifier, to your router.

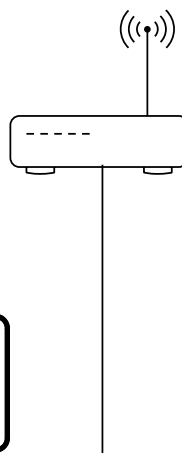
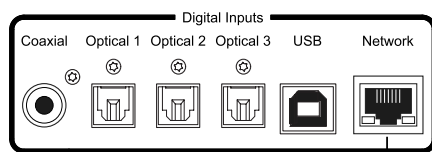

Network settings

The amplifier has its own Network Configuration page where you can change the amplifier's network name and IP settings.

To open the page, enter your amplifier's IP address in a browser window.

You can find the IP address in the [Device Menu](#) under "Network".

For detailed information on the Network Configuration page, supported formats, and much more, please visit support.hegel.com



NOTE: Some of the features of the Hegel device require an internet connection.

Status Indicators

The Hegel device will display the network status in the lower left corner of the display.

Network status is OK:



Troubleshooting

If you experience problems with connecting the amplifier to the network or have other network issues, disconnect the power chord for at least 30 seconds, and then reconnect.

IP control

The amplifier can be controlled by external smart home systems via IP control. For drivers and more information, please visit support.hegel.com

Streaming

AirPlay

With Apple AirPlay you can stream audio from an AirPlay compatible device to the Hegel device.

Choose the Hegel device in the list of AirPlay speakers. Go to apple.com/airplay to learn how.



Spotify Connect

Spotify is a digital music, podcast, and video streaming service that gives you access to millions of songs and other content from artists all over the world. You can stream audio from Spotify to the Hegel device.

Use your phone, tablet or computer as a remote control for Spotify.

Go to spotify.com/connect to learn how.



Roon Ready

Roon is a music management and listening solution that is dedicated to high sound quality and exceptional user experience.

You can stream audio from Roon to the Hegel device. Go to hegel.com/roon to learn more and to register for a free trial period.



UPnP/DLNA

UPnP stands for Universal Plug and Play and is a widely used media streaming protocol that is supported by a host of media player products and applications. The Hegel device functions as a digital media renderer. When using UPnP/DLNA you can stream from locally stored files or music streaming services to the Hegel device. For details on how to set up your media player, please refer to the user manual supplied with the player.

WARNING:

[When streaming to the Hegel device, always remember to check the player/device volume setting before pressing play. The Hegel device will change its volume to the volume set in the player.](#)

Device Menu

Navigation

To enter the device menu, turn the Hegel device on and press and hold the COMPUTER PLAY button for 5 seconds. To navigate the menu, use the PREV and NEXT buttons.

To select a sub-menu or feature, press the PLAY button. To exit the menu, navigate to "Exit" and press PLAY. or turn one of the amplifier's knobs.

NOTE: Some menu features require a connection to the internet to work properly. See [Network Setup](#).

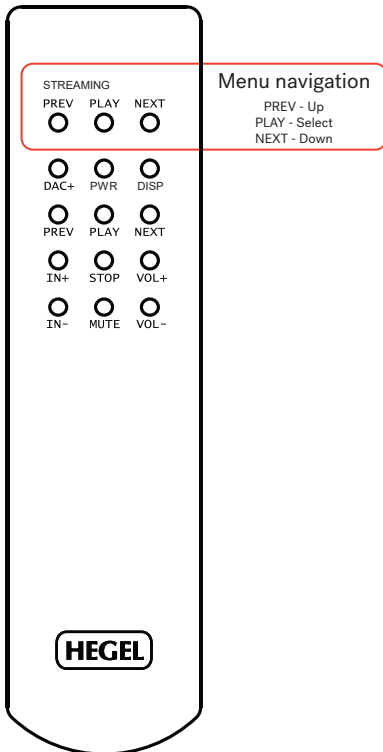

Info

Information about the Hardware Version of your product and the Software Version currently running.

Network

Information about the Network Device Name and the IP Address of your product.

Update

Check for and download the newest software for your product.

Sleep

By default, this Hegel device will automatically go into standby mode after 15 minutes without music, or with a very low signal on the speaker outputs. The Sleep timer can be adjusted or disabled in this menu.

Volume

Adjust maximum volume and maximum startup volume.

Remotes

Enables you to use your TV remote to turn on your Hegel device and adjust its volume. You can also configure automatic input selection and automatic power on.

*Works with most newer Samsung, Sony, LG, and Philips IR and Smart TV remotes.

HT

Most inputs can be configured to act as a Home Theater input. This will set the input volume at a fixed high volume level. Only connect sources with volume control.

Reset

Reset the product to the default factory settings. This will not affect any firmware updates you have installed.

Exit

Exit the menu

NOTE: The Hegel device menu can be updated with new features and options.

For an up-to-date and in-depth description of the menu and its features, please visit support.hegel.com



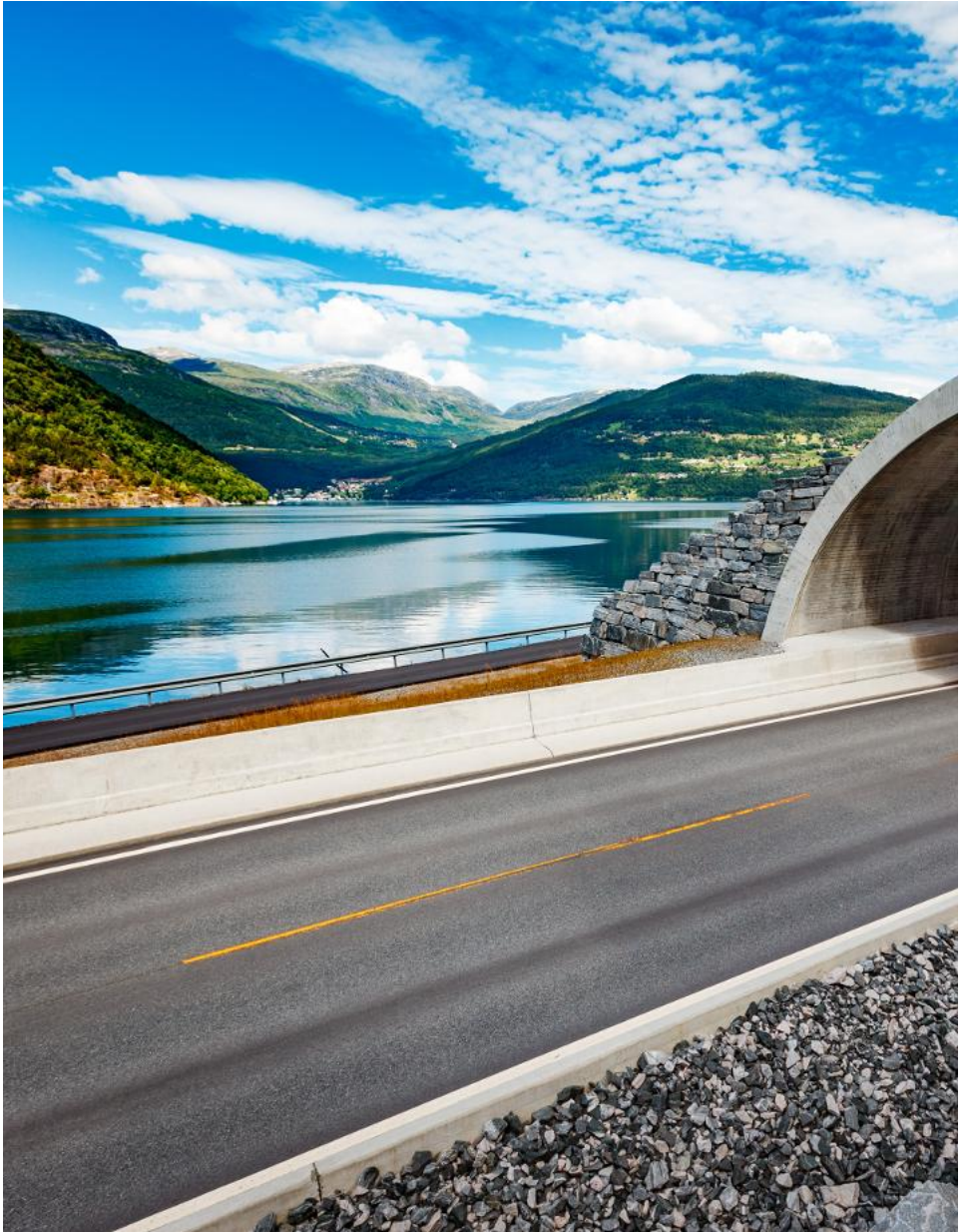

General Information

Connecting a subwoofer

The most common way to connect a subwoofer is from the variable line output on your Hegel amplifier. If your subwoofer is equipped with “high-level” speaker wire terminals, you can also use this. Many subwoofer manufacturers recommend this type of connection if it is available.

Please consult your subwoofer manual for detailed instructions on how to connect and configure your subwoofer for the best audio result.

Power

All electrical components should be turned off or set in standby mode when not in use. This is due to safety, because all electrical components can fail, and it is good for the environment. Leaving your product on all the time could also shorten the life expectancy of the product.

That being said, our products sound even better when they are warmed up, typically after about 15 minutes of listening at a moderate volume.

Connecting your TV

The best way to connect your TV is by using one of the optical inputs. If there is no sound, try changing the sound output in the TV’s settings menu. The setting should be changed to “optical” or “digital out” and the signal should be “PCM” or “stereo”. Please consult your TV manual for detailed instructions.

The volume on this device can also be controlled by certain TV remotes. See [Device Menu](#) for more information.

Technical Specifications

H190v Integrated Amplifier

Power output	2*150W in 8 ohms
Minimum load	2 ohms
Analog inputs	1*Balanced (XLR) 2*Unbalanced (RCA)
Phono input	1*Unbalanced (RCA) for Moving Magnet (MM)
Digital inputs	1*Coaxial S/PDIF, 24/192 3*Optical S/PDIF, 24/96 1*USB, 24/96 1*Network, 24/192
Line level outputs	1*Unbalanced fixed (RCA) 1*Unbalanced variable (RCA)
Streaming	AirPlay, Roon Ready, Spotify Connect, UPnP
Streaming formats	MP3, WAV, FLAC, ALAC, AAC, PCM, Ogg
Frequency response	5Hz-100kHz
Signal-to-noise ratio	More than 100dB
Crosstalk	Less than -100dB
Distortion	Less than 0.01% @ 50W 8 Ohms 1kHz
Intermodulation	Less than 0.01% (19kHz + 20kHz)
Damping factor	More than 4000 (main output stage)
Power use in standby	<0,5W
Dimensions/weight	12 x 43 x 41cm (HxWxD), 14,2kg
Dimensions/weight US	7,72 x 16,93 x 16,15” (HxWxD), 31,3 lbs

Safety Instructions

Unpacking and Packing

Remove the top shock absorber. When lifting the amplifier, avoid holding the knobs or connectors. Slide the bag off/on the device. When packing, make sure the bottom shock absorber is placed at the bottom of the original cardboard box. Place the amplifier into the shock absorber. Place the top shock absorber on top of the amplifier.

Placement and Cooling

The Hegel amplifier should be placed on a flat, hard surface for proper cooling. The amplifier must never be placed on a carpet or similar surface as this obstructs air circulation through the unit. To maintain proper ventilation, leave a space of a minimum of 10 cm from the rear, top, and side panels of the device. The front side of the enclosure should be left open.

If overheated, the amplifier will automatically switch itself off. When it cools down the amplifier will turn back on, and the volume will be set to 0.

Warning: The surfaces of the amplifier may become hot during use. If hot, do not touch the panels of the amplifier, and let the amplifier cool down before moving or lifting it.

Connecting the wires

Incorrect connections or damaged wires can cause short circuits, which can damage the amplifier, cause electrical shock, and pose a fire hazard. Follow this manual's installation instructions and ensure all wires are connected correctly before connecting the power source.

Power source

Only use the power source specified on the back panel and ensure the voltage matches the voltage in your area.

High volume

Do not listen to music at high volumes for extended periods of time as this can cause permanent hearing damage and the inability to enjoy this amplifier to its fullest.

Cleaning

Unplug the amplifier from the AC outlet before cleaning. Fingerprints or stains can be removed with a cloth lightly dampened with warm water or a mild detergent suitable for cleaning mirrors and windows.

Proper use

Use the amplifier only for its intended purpose and do not modify or misuse it in any way. The product is designed for indoor use only and must not be exposed to rain or moisture.

Repair

Hegel products should only be opened or serviced by certified technicians. The devices contain electronic components that may cause severe electric shock. Work performed on Hegel products by unqualified personnel may cause serious damage or personal injury.

Opening the product by non-authorized personnel will void the warranty.

Warranty and Disclaimers

Warranty

All Hegel products come with a 2-year warranty against defective materials and workmanship. The warranty is limited to the region where it was originally purchased. There is no need for registering the warranty. The purchase receipt will work as a start date for the warranty.

In case you need assistance with your Hegel product, please contact your nearest dealer or distributor. These are listed on www.hegel.com. Our dealers are carefully chosen for their expertise and should be able to help you with any Hegel-related issue. You can of course always reach us directly by sending an email to info@hegel.com or by contacting us on our social media pages.

For more information about the H190v, please visit www.hegel.com

Disclaimers

Use of the Works with Apple badge means that an accessory has been designed to work specifically with the technology identified in the badge and has been certified by the developer to meet Apple performance standards.

Apple and AirPlay are trademarks of Apple Inc., registered in the U.S. and other countries and regions.

The Spotify Software is subject to third party licenses found here:

www.spotify.com/connect/third-party-licenses

Being Roon Ready means that Hegel uses Roon streaming technology, for an incredible user interface, simple setup, rock-solid daily reliability, and the highest levels of audio performance, without compromise.

The TV remote functionality is not guaranteed to work with all TV remotes from the supported brands.

Technical specifications, streaming options, and features may change without notice.



V1



